

# Colorado Springs Pioneers Museum



## Self-Guided Learning Packet



Name: \_\_\_\_\_

Grades: 2-5  
STUDENT GUIDE

### Connection to Standards • History

- 2nd: 1.1.1.a, b, c, d, e; 1.2.2.a, c, e
- 3rd: 1.1.1.a, b; 1.2.2.a, b, c
- 4th: 1.1.1.a, b, c, d
- 5th: 1.1.1.a, b; 1.2.2.b

## UPPER LEVEL

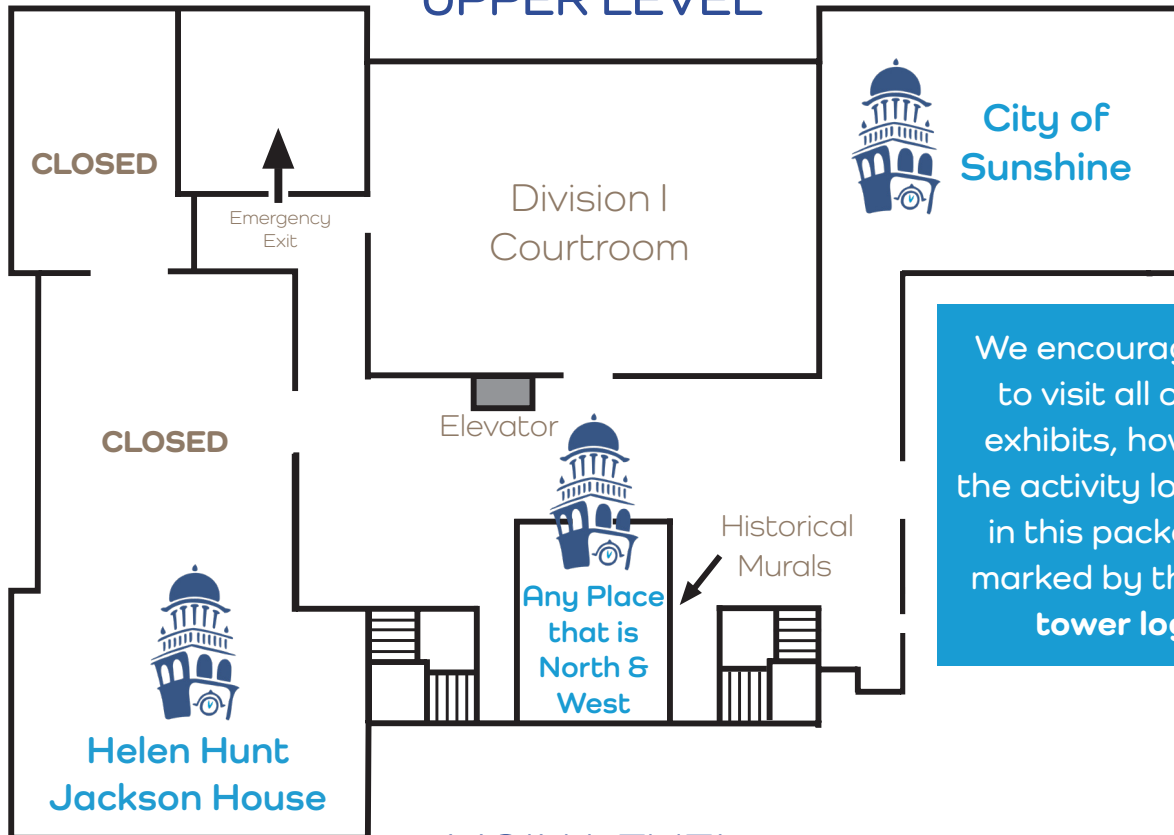

We encourage you to visit all of the exhibits, however, the activity locations in this packet are marked by the **blue tower logo**.

## MAIN LEVEL

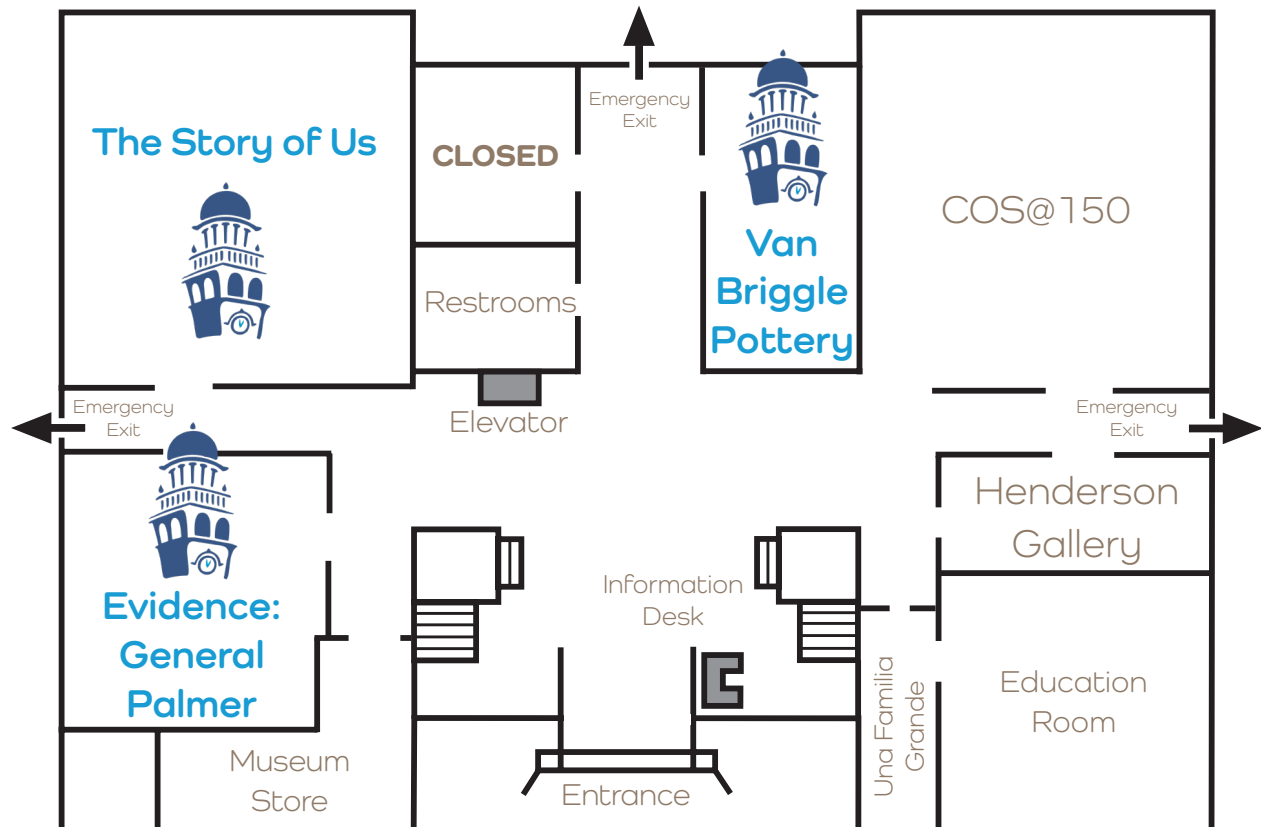

Share photos from your visit!  
**@cspioneersmuseum**



PRIMARY SOURCE  
SEARCH

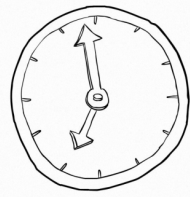

TIMELINE  
TIME-OUT

AWESOME  
ARTIFACTS



FACT VS.  
FICTION

WRITE &  
REFLECT

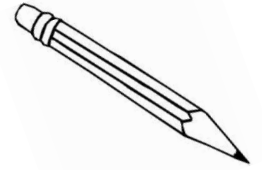

## STORY OF US



Read the labels for each of the four letters in the exhibit to find the dates for the questions below. Add the events to the timeline in **chronological order** (from the longest ago to the most recent).

1. **D: Soap Box Derby** - When was the first official Soap Box Derby Race held? \_\_\_\_\_
2. **V: Vallejos Restaurant** - What year did the restaurant open? \_\_\_\_\_
3. **B: Bloomer Girl** - What year did Julia Archibald Holmes travel to Colorado? \_\_\_\_\_
4. **X: X Marks the Spot** - When was Colorado Springs Founded? \_\_\_\_\_



## EVIDENCE: GENERAL PALMER



**William Jackson Palmer** founded Colorado Springs in 1871. This exhibit uses primary sources as evidence to tell his and his family's story.



General William  
Jackson Palmer

**Primary sources** are first-hand, original accounts or evidence about a person, place, object, or an event. Look for the three types of primary sources listed below and **draw an example** from the exhibit:

Object/Artifact

Handwritten Document

Photograph



# VAN BRIGGLE POTTERY

**Artus Van Brigg** was one of many people who came to Colorado Springs to recover from an illness called Tuberculosis. While he was here he created and sold artwork.



Artus & Anne  
Van Brigg

Look around the exhibit and write **TRUE** or **FALSE** for each: The Van Brigg's made...



- Clothing \_\_\_\_\_
- Pottery \_\_\_\_\_
- Paintings \_\_\_\_\_
- Tiles \_\_\_\_\_
- Quilts \_\_\_\_\_



Can you find this cast of hands made out of clay? Who's hands are these?

\_\_\_\_\_

\_\_\_\_\_

Take the 1917 birdcage elevator to the 3rd floor/upper level!

# HELEN HUNT JACKSON's HOME



Welcome to the *actual* home of famous author and activist, **Helen Hunt Jackson**! Explore the exhibit. Can you find the name of one of the books she wrote?

\_\_\_\_\_



A person's home is a wonderful place to discover the past! Explore the house to find the objects in the pictures below and discuss the questions for each item.



Can you spot the fancy ink well on Helen's desk?

Helen loved nature. Can you find any other items from nature in her home?



Helen enjoyed traveling around the world. Do you buy special souvenirs on your trips?



Helen fought for the rights of American Indians. What part of the country did Helen get this Mission Indian basket tray from?



# ANY PLACE THAT IS NORTH & WEST

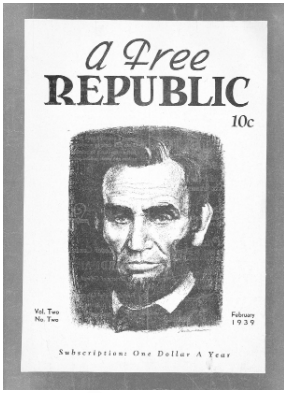

Visit the **Any Place That is North and West** exhibit.  
Can you find this volume of the magazine **A Free Republic**?

**Gretchen McRae, a local writer and Civil Rights activist,**  
**published this national magazine.**

How much did this magazine cost in 1939? \_\_\_\_\_

People like Gretchen McRae have worked to make positive changes in the world.

What problem would you work to change today?

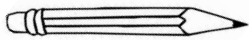

---

---

---

---

# CITY OF SUNSHINE

The Modern Woodmen Sanatorium -  
A treatment center for TB patients



Many people came to Colorado Springs to recover  
from a disease called tuberculosis - "TB" (or  
consumption).

By looking at different **primary sources and the text** in the  
exhibit can you list **two reasons** why Colorado Springs was a  
good place to recover from this disease?

1. \_\_\_\_\_
2. \_\_\_\_\_

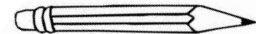

Find the video at the entrance of the  
train worker. He says:

**"The atmosphere is  
free from all germ life."**

Do you think this is true or false? (circle one)

**TRUE**

**FALSE**



Why do you think the train worker said  
this **false** statement?

---

---

---

---

# My Timeline

Choose (3) events from your life.

**Draw a picture** of the event and

**write** what the event was.

DRAW

WRITE

Birth ---->---->---->---->----> Today